

$\varnothing 25.4_{-0.1}^0$

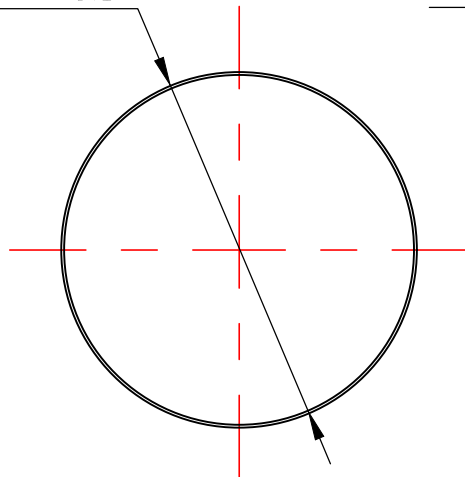

3 ± 0.1

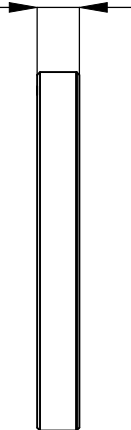

NOTES/SPECIFICATIONS:

1. MATERIALS: BK7
2. APERTURE: >85%
3. SURFACE QUALITY : 10/5 S/D
4. PARALLELISM: <10 ARC SECONDS
5. CHAMFER: 0.2mm x 45 DEGREE
6. FLATNESS: $\lambda/4$ @ 633nm
7. COATING: AR/AR@1100nm~1650nm(REFER TO COATING CURVES)
8. DIMENSION IN mm

FOR INFORMATION ONLY
NOT FOR MANUFACTURING PURPOSES

DRAWING
PROJECTION

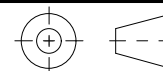

| | NAME | DATE |
|----------|------|------------|
| DRAWN | LLL | 18/June/20 |
| APPROVAL | JT | 18/June/20 |

COPYRIGHT © 2020 BY SHALOM EO

SHALOM EO

www.shalomeo.com

BK7 D25.4x3mm WINDOWS WITH
AR@1100nm~1650nm COATING

| | | | |
|----------|---------|------------|-----|
| MATERIAL | BK7 | REV | A |
| ITEM # | 131-016 | PROPORTION | 1:1 |